

2025CPT.12.11.20232, Etc.

**This electronic collection of documents is provided
for the convenience of the user
and is Not a Certified Document –**

**The documents contained herein were originally issued
and sealed by the individuals whose names and license
numbers appear on each page, on the dates appearing
with their signature on that page.**

**This file or an individual page
shall not be considered a certified document.**

DL00346

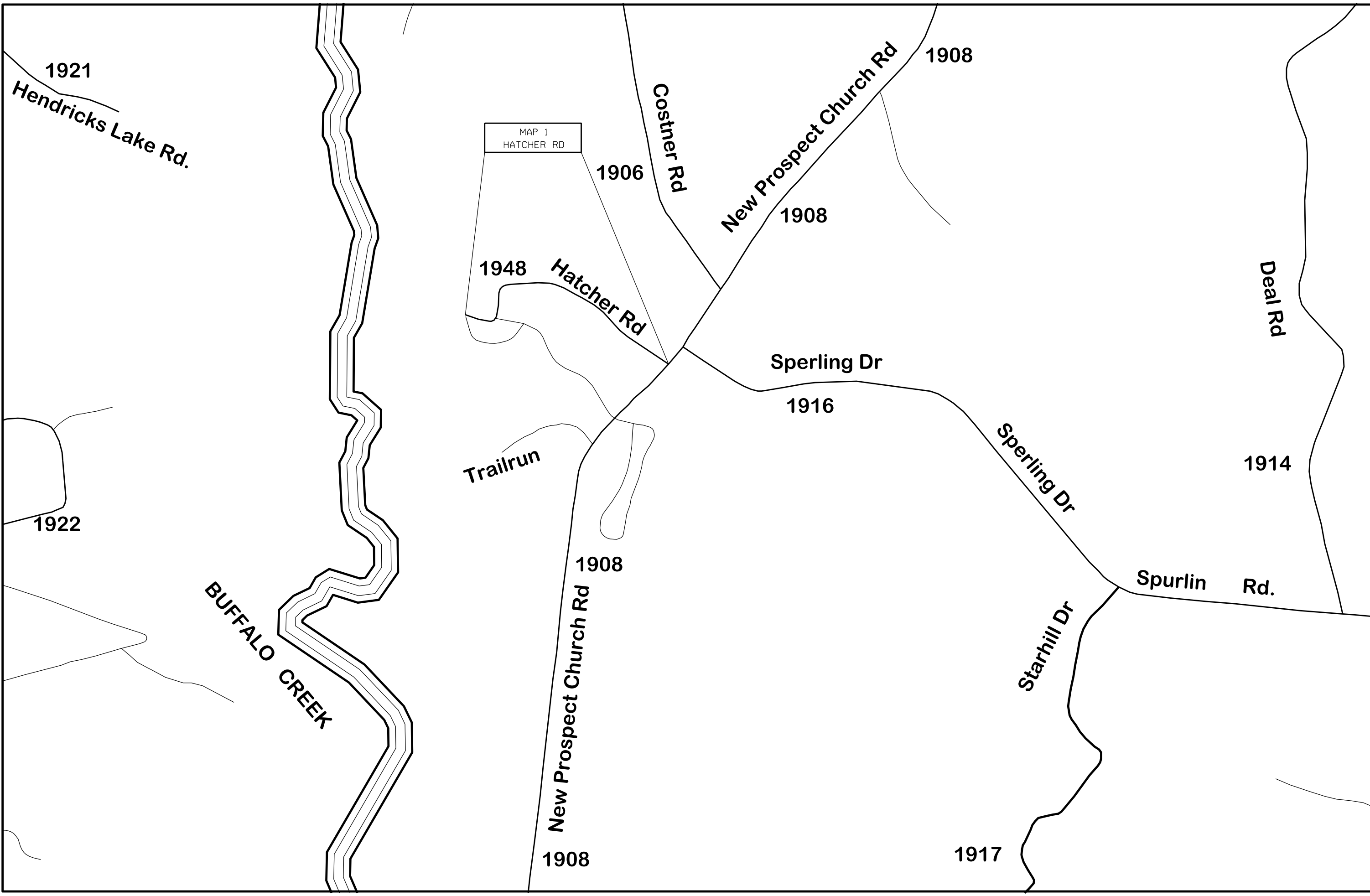

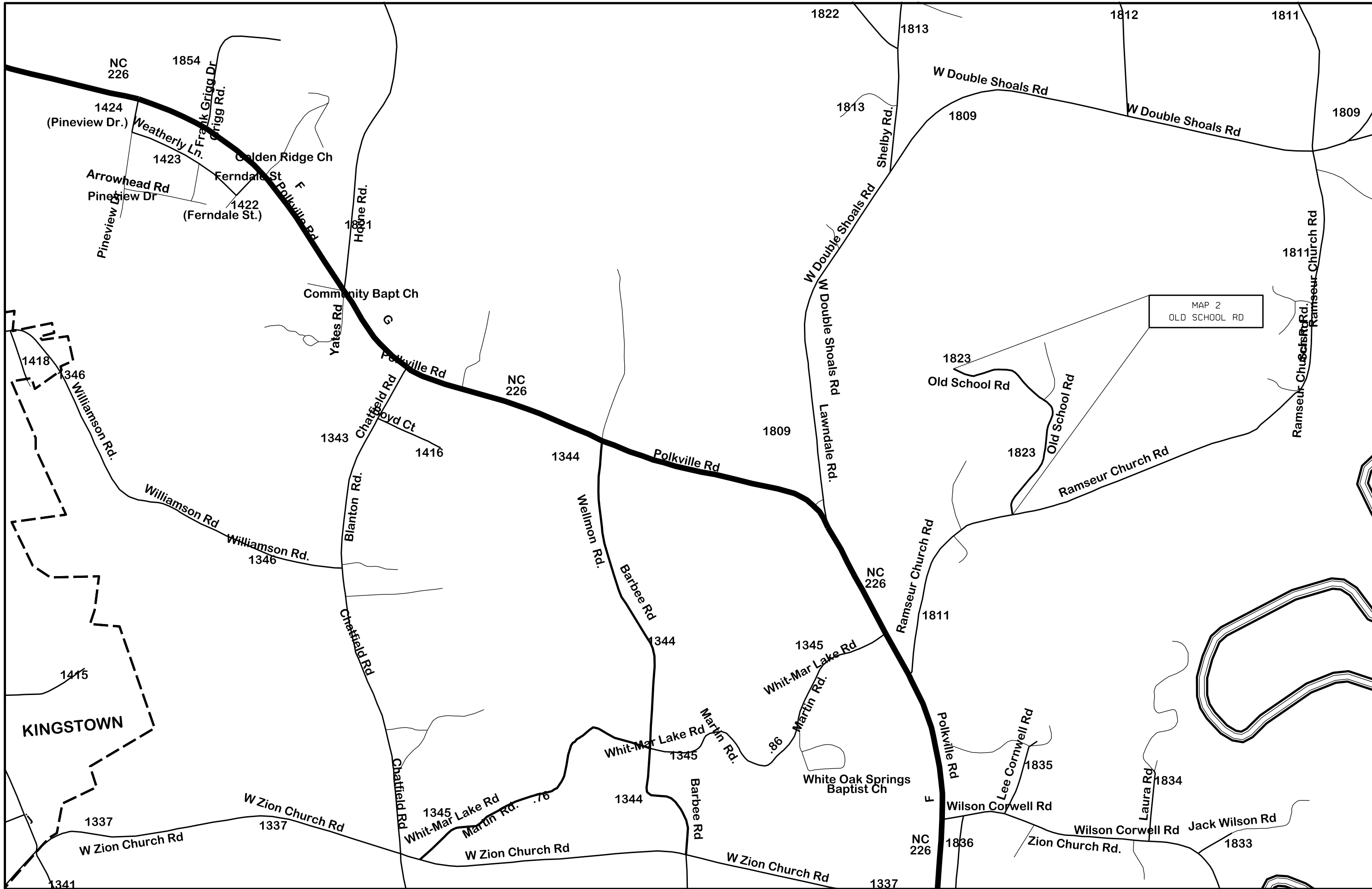

CLEVELAND COUNTY
 2025CPT.12.11.20232

KINGSTOWN

MAP 2
 OLD SCHOOL RD



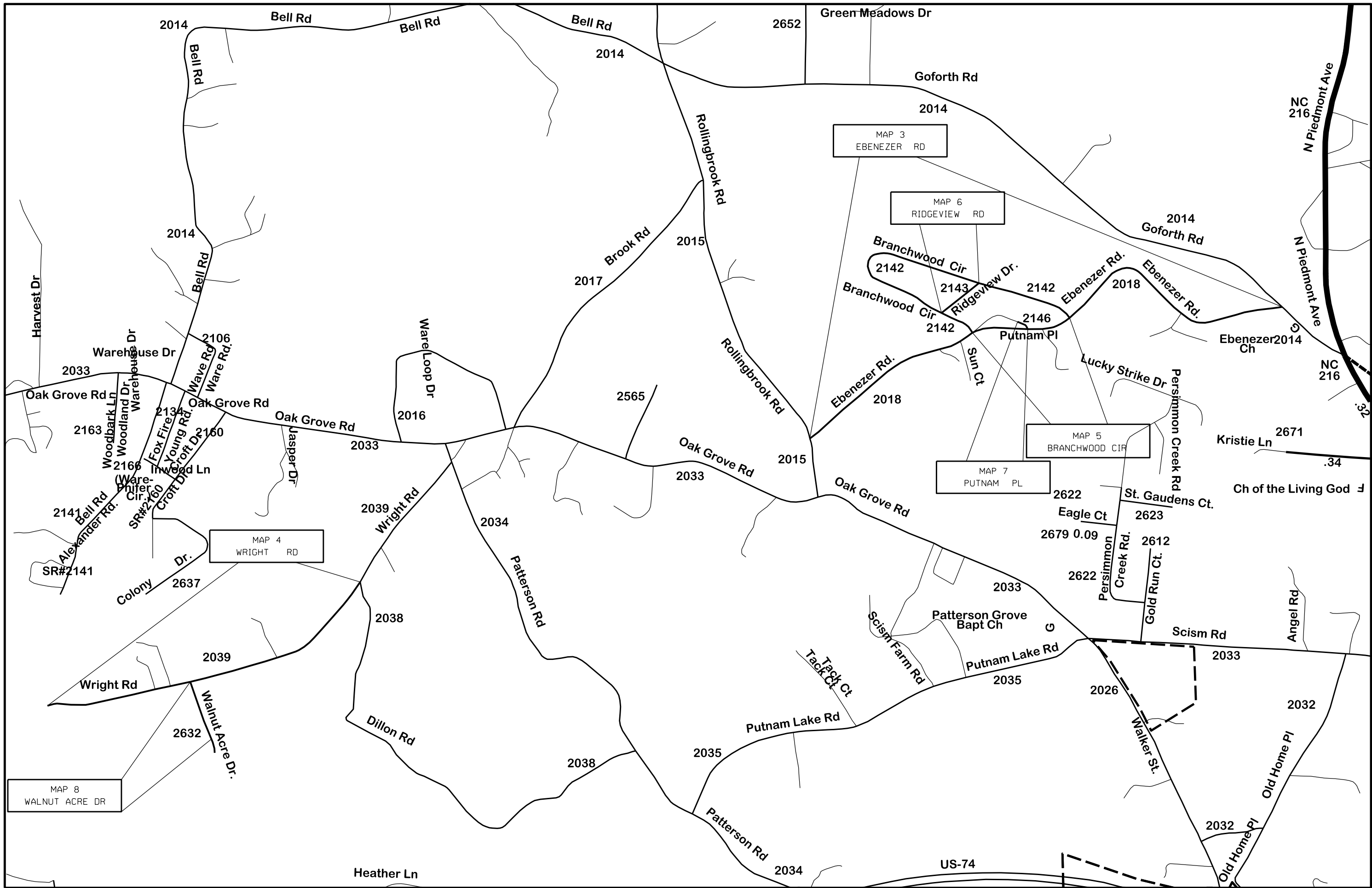

CLEVELAND COUNTY
 2025CPT.12.11.20232

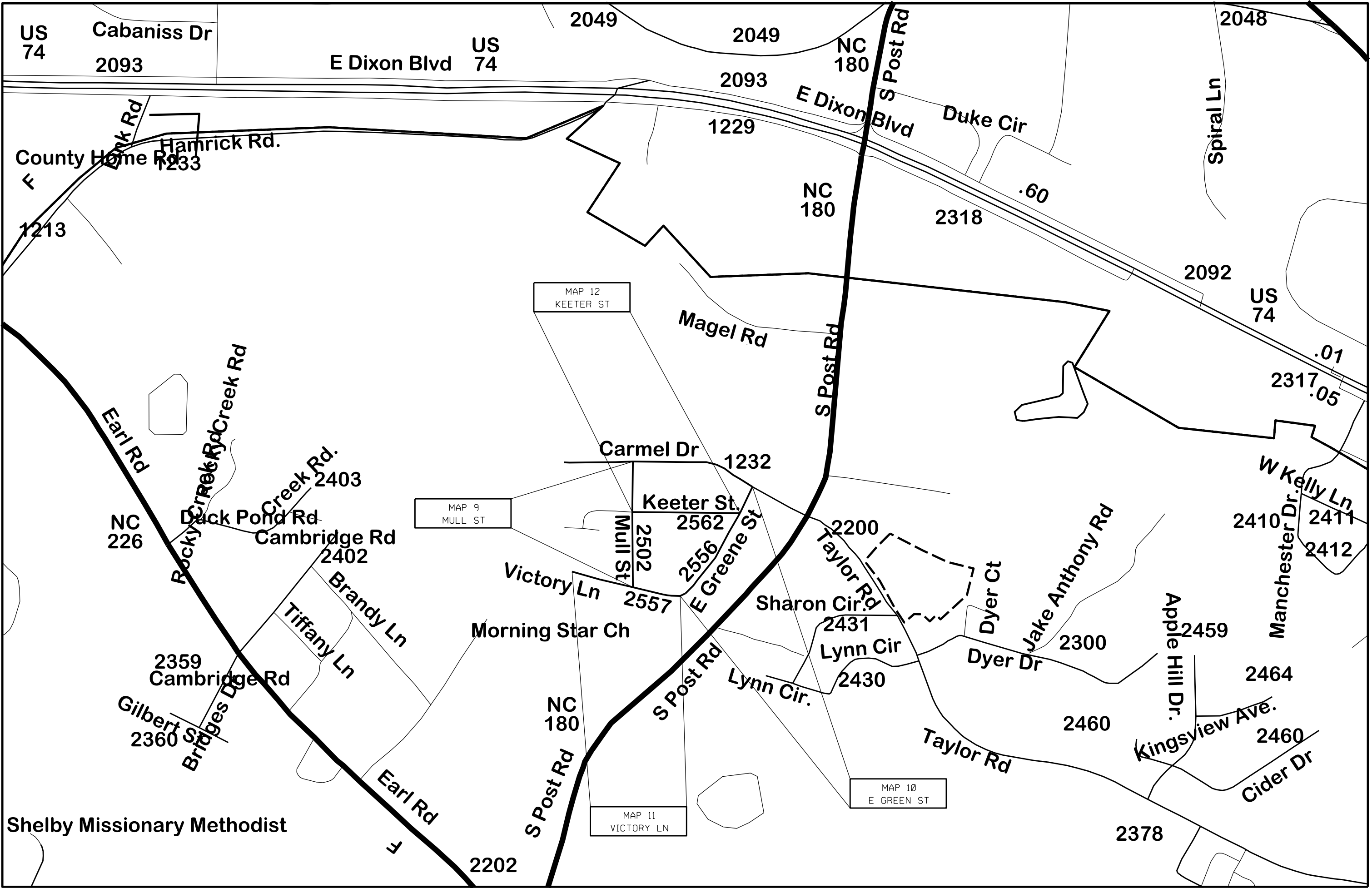

US 74
Cabaniss Dr
2093

E Dixon Blvd

US 74

2049

2049

NC 180

2048

County Home Rd
1213

Hamrick Rd.
1233

2093

E Dixon Blvd

Duke Cir

Spiral Ln

1229

NC 180

2318

.60

2092

US 74

.01

2317
.05

MAP 12
KEETER ST

Magel Rd

S Post Rd

Earl Rd

Rocky Creek Rd
Creek Rd

Creek Rd.
2403

Carmel Dr 1232

NC 226

Duck Pond Rd
Cambridge Rd
2402

MAP 9
MULL ST

Keeter St.
2562

Mull St
2502

E Greene St
2556

2200

Taylor Rd

W Kelly Ln
2410
2411
2412

Victory Ln 2557

Sharon Cir.
2431

Dyer Ct

Jake Anthony Rd
2300

2359
Cambridge Rd

Gilbert St
2360
Bridges Dr

Tiffany Ln
Brandy Ln

Morning Star Ch

Lynn Cir.
2430

Dyer Dr

Apple Hill Dr.
2459

2464

2460

Kingsview Ave.
2460
Cider Dr

Shelby Missionary Methodist

Earl Rd
F
2202

NC 180
S Post Rd

MAP 11
VICTORY LN

MAP 10
E GREEN ST

Taylor Rd

2378



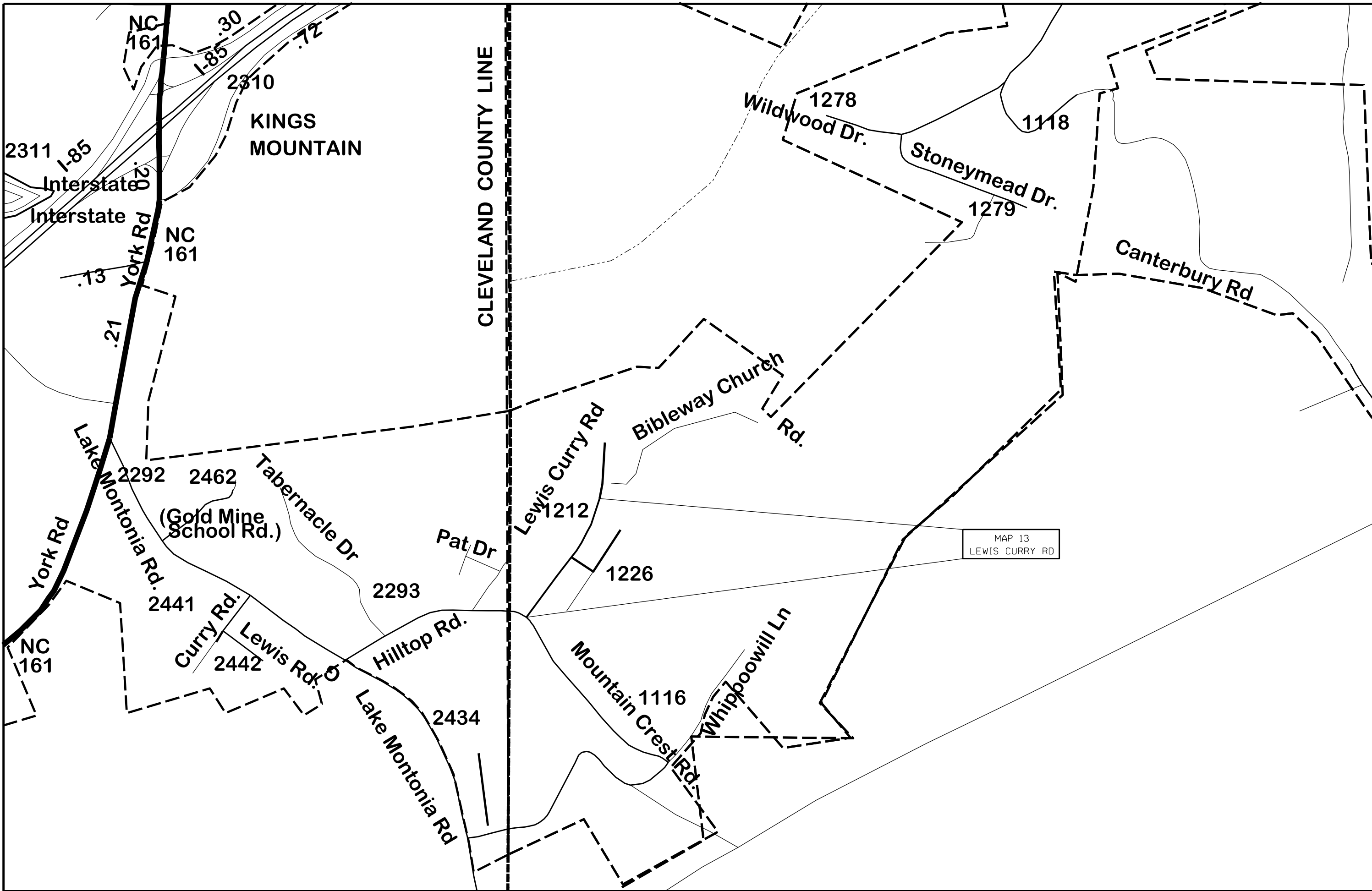

GASTON COUNTY
2025CPT.12.11.20362



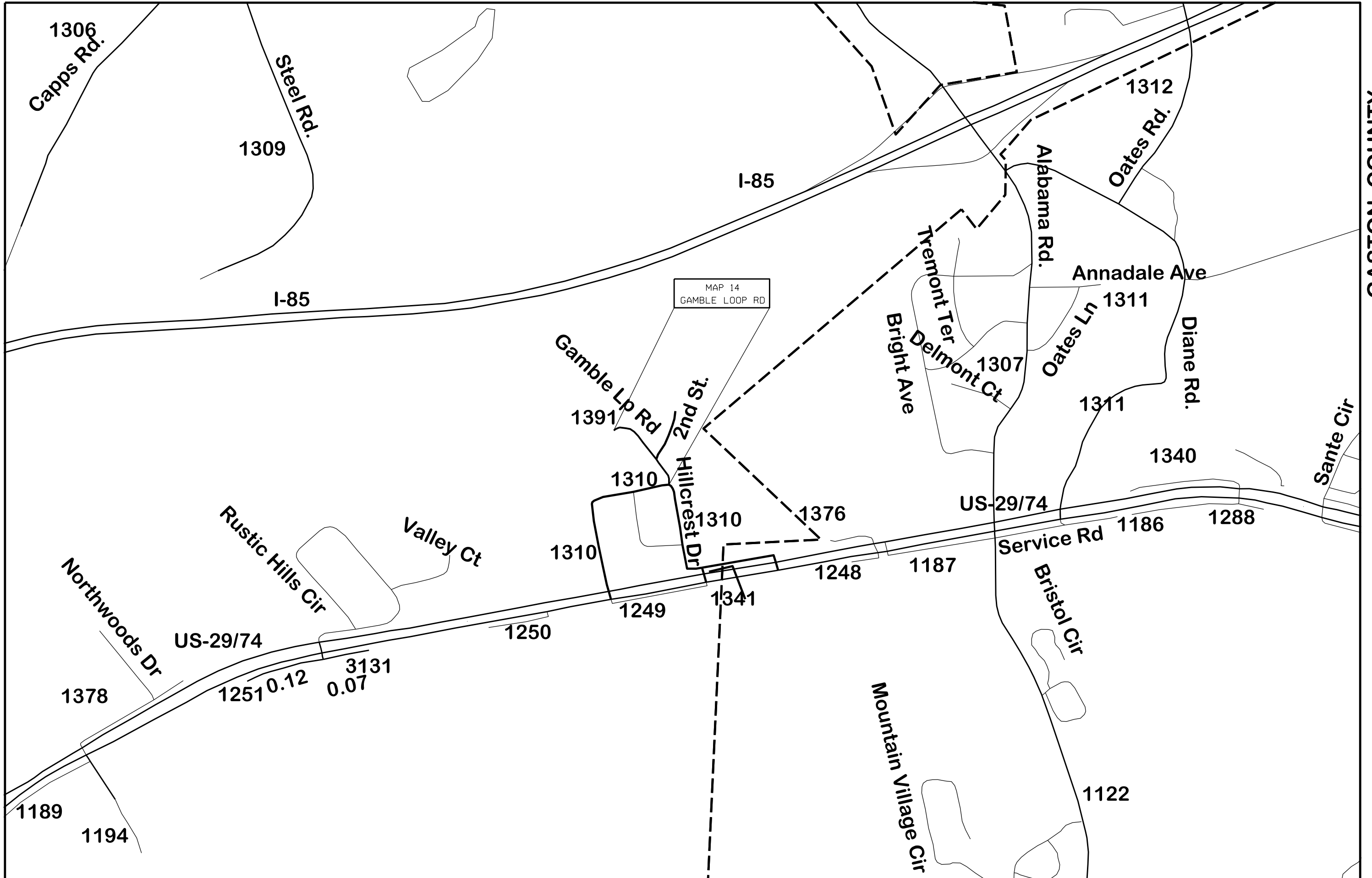

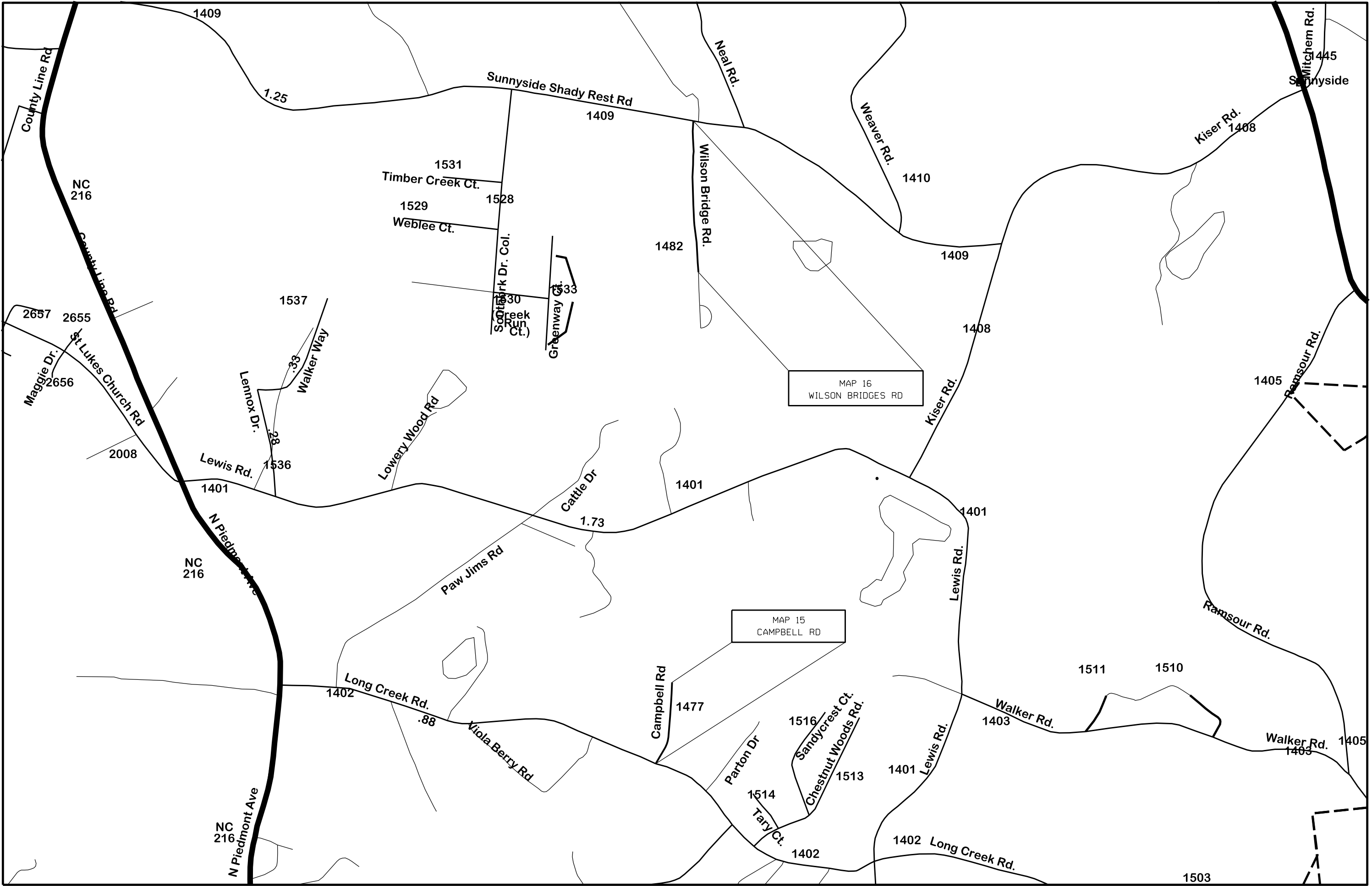

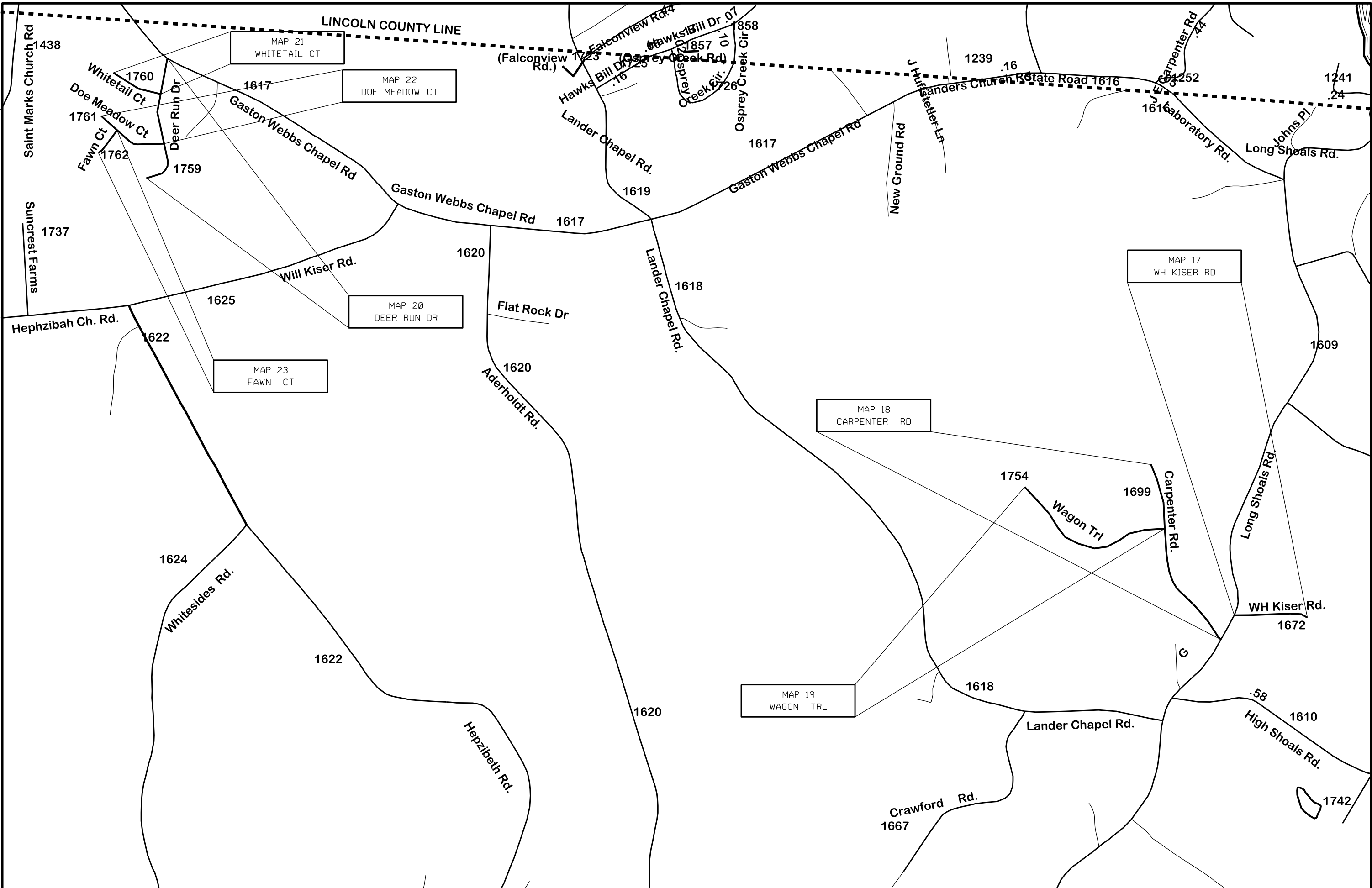

GASTON COUNTY
 2025CPT.12.11.20362



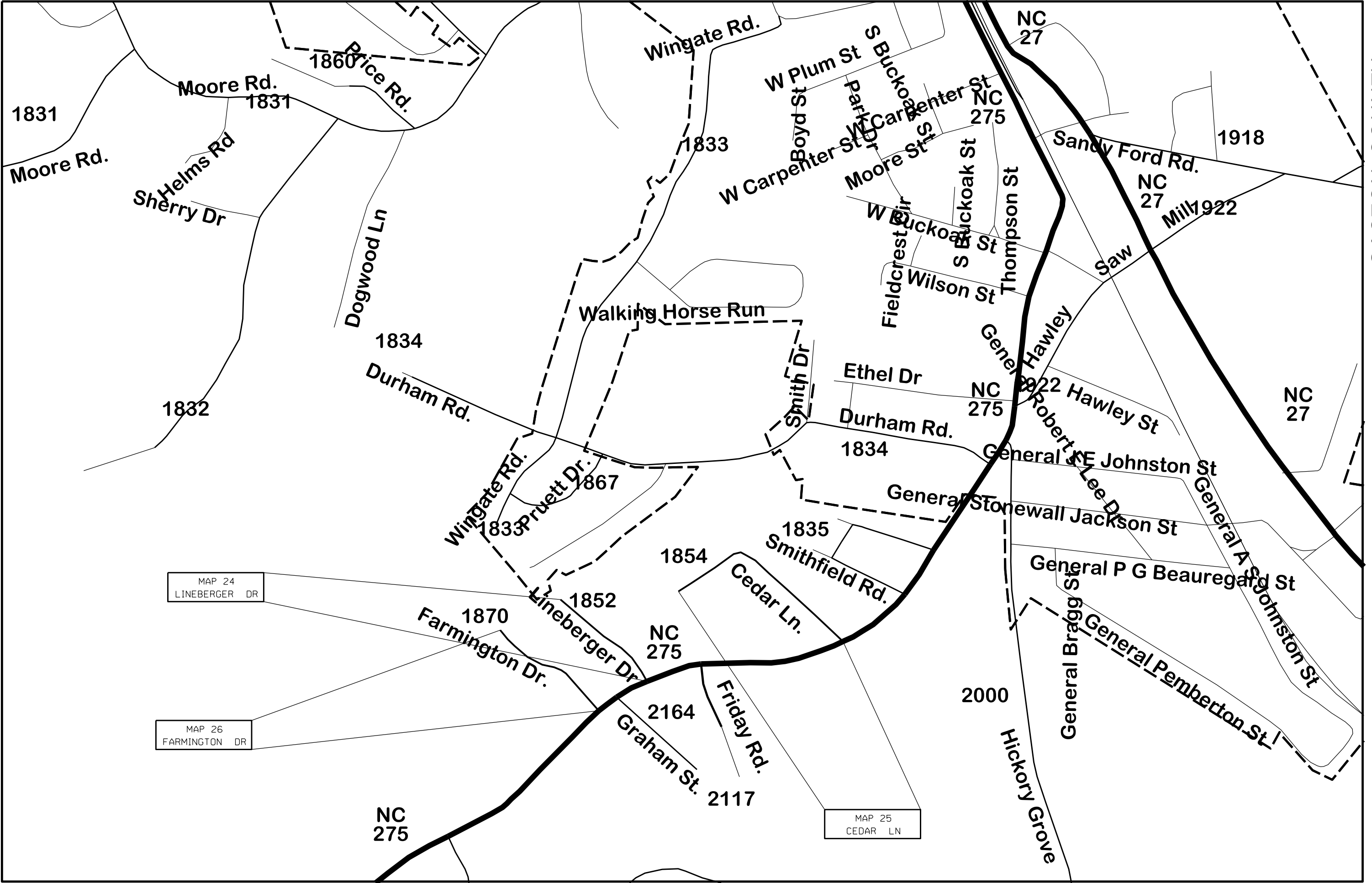

MAP 24
LINEBERGER DR

MAP 26
FARMINGTON DR

MAP 25
CEDAR LN



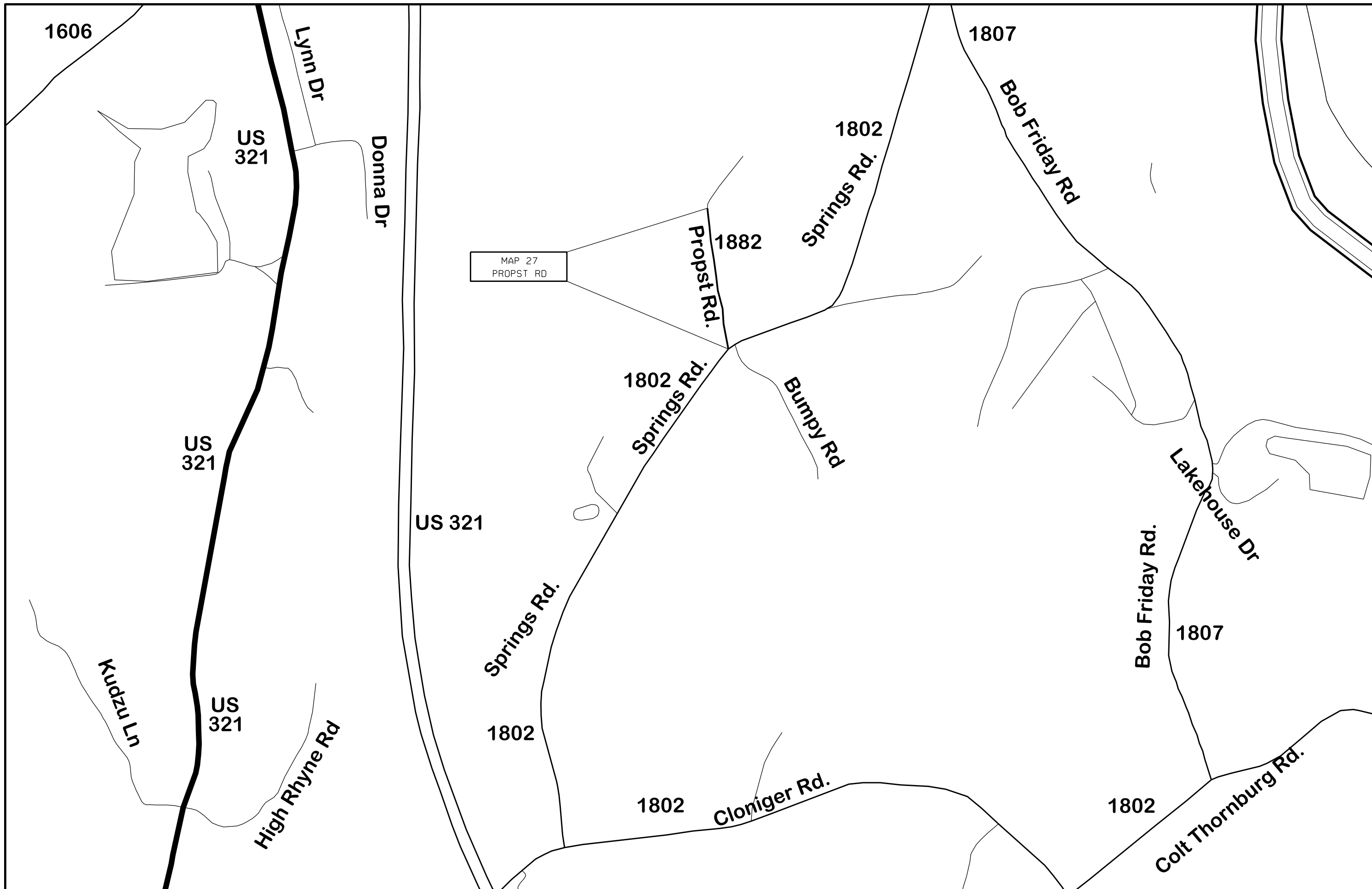

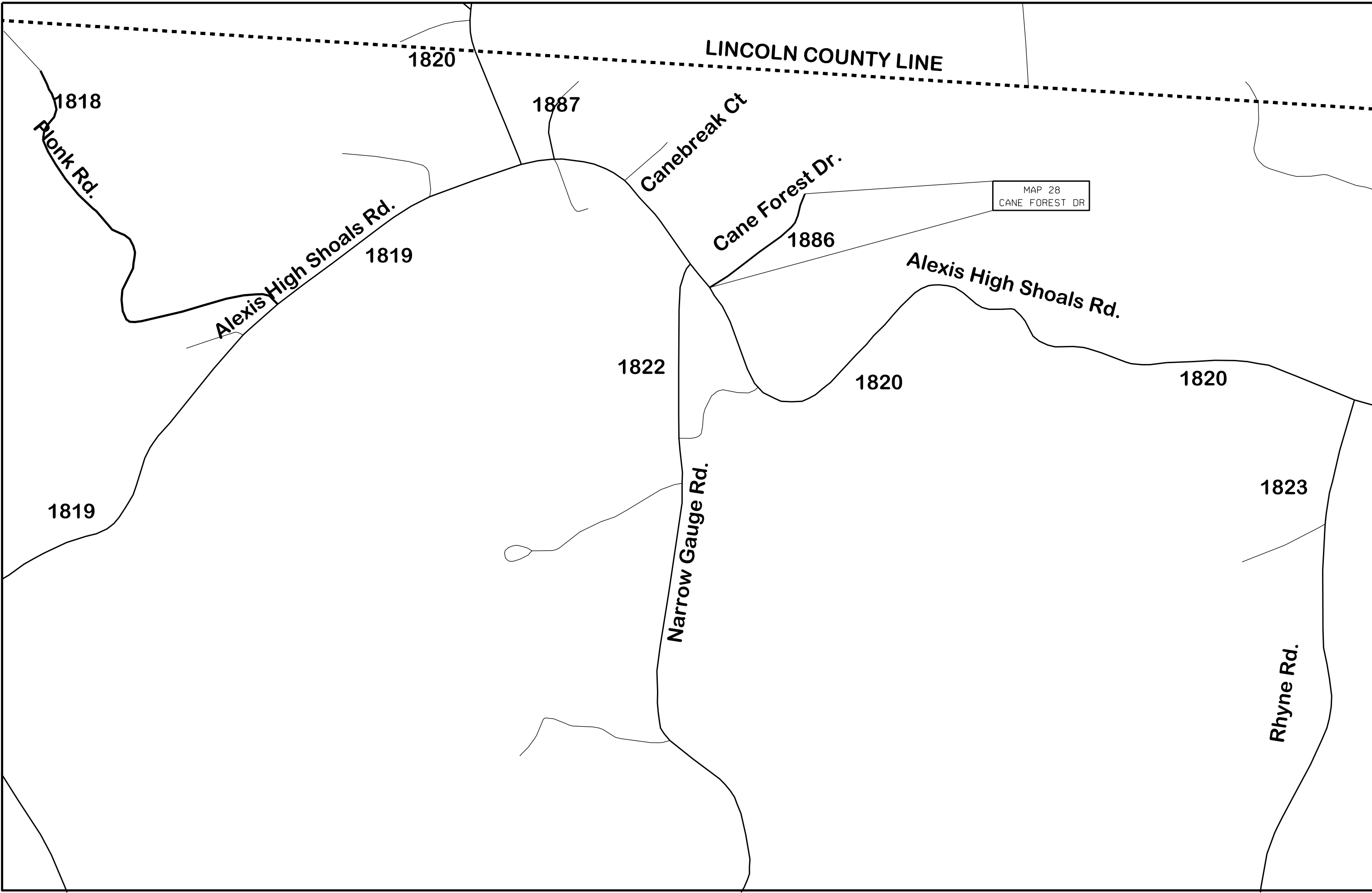

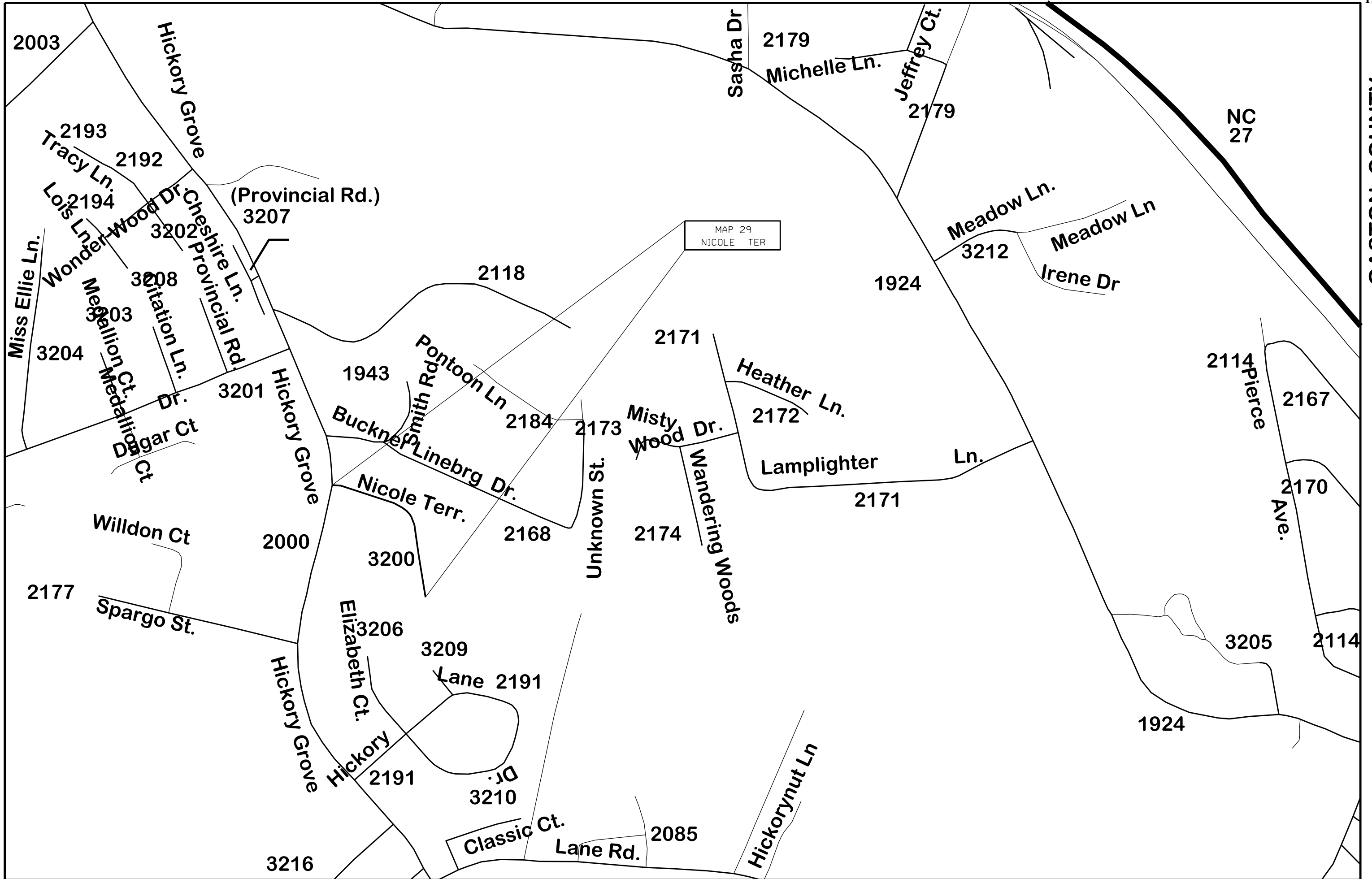

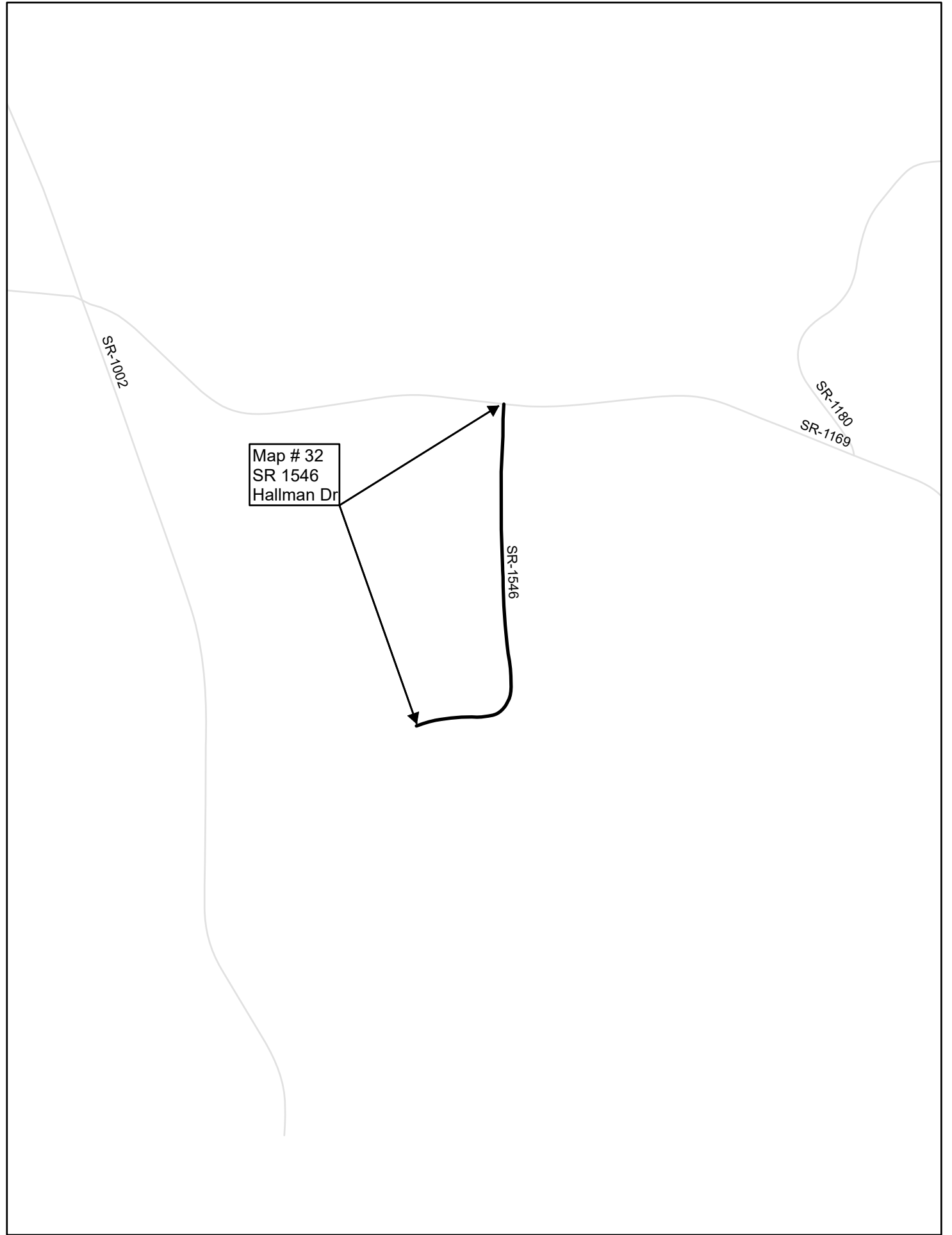
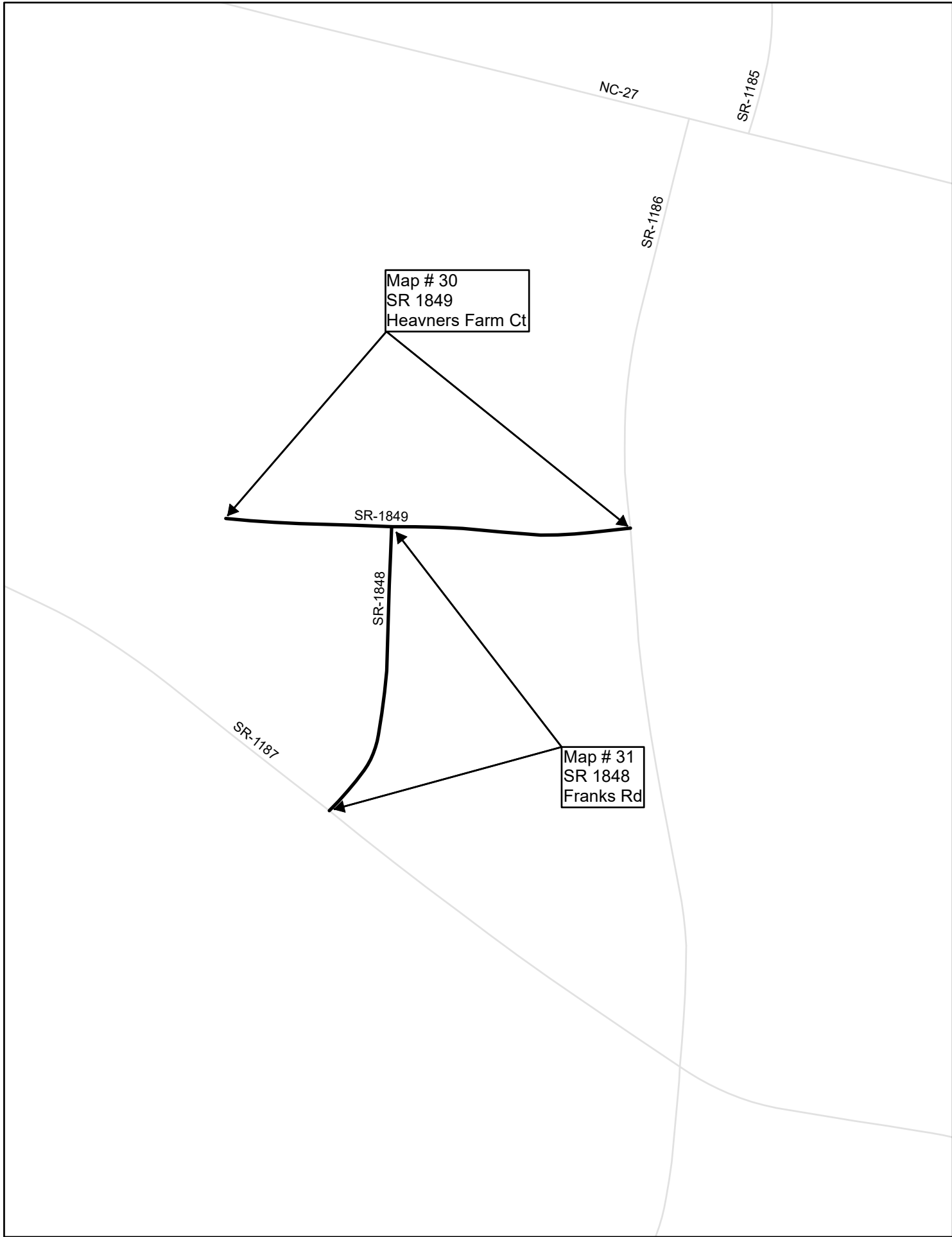

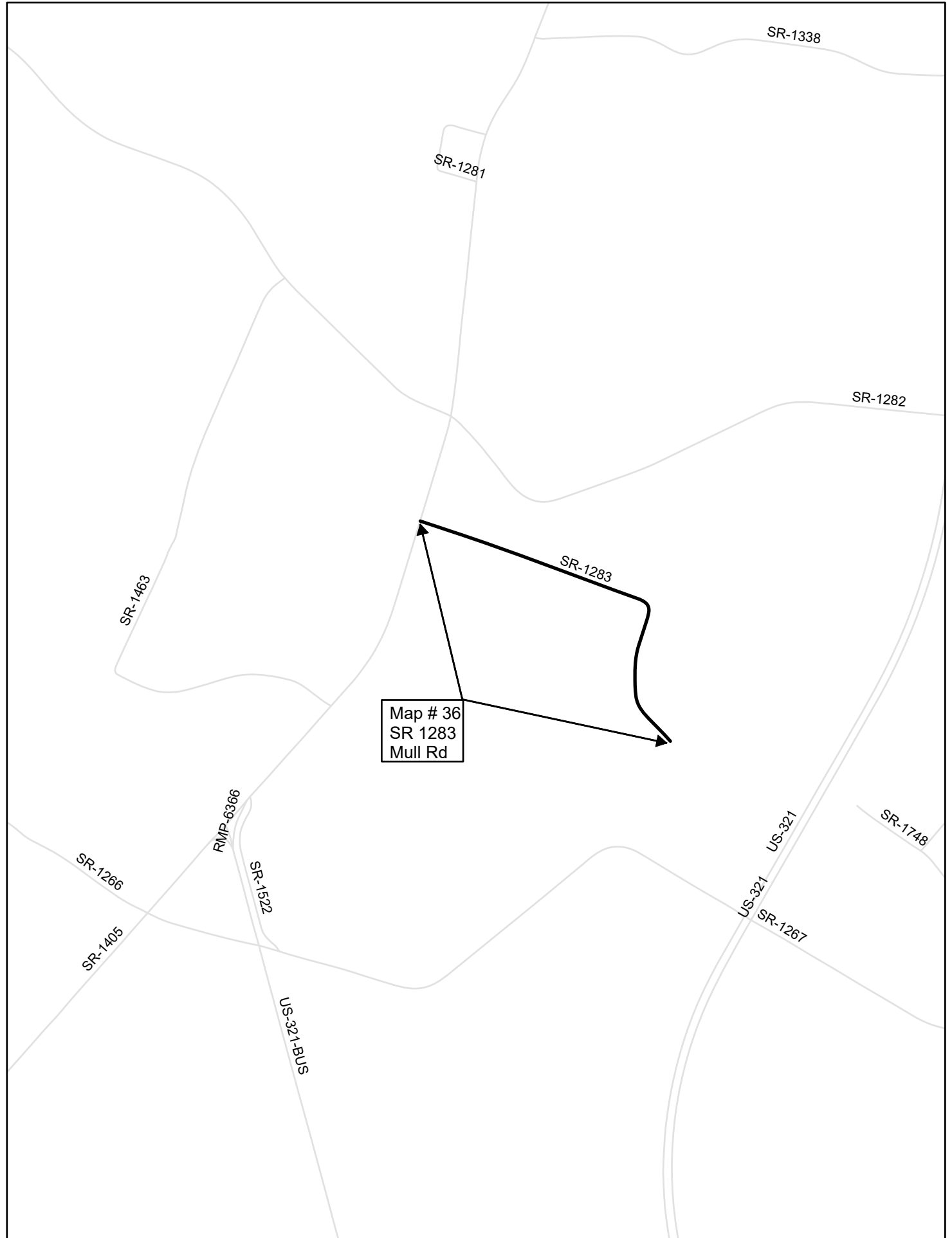
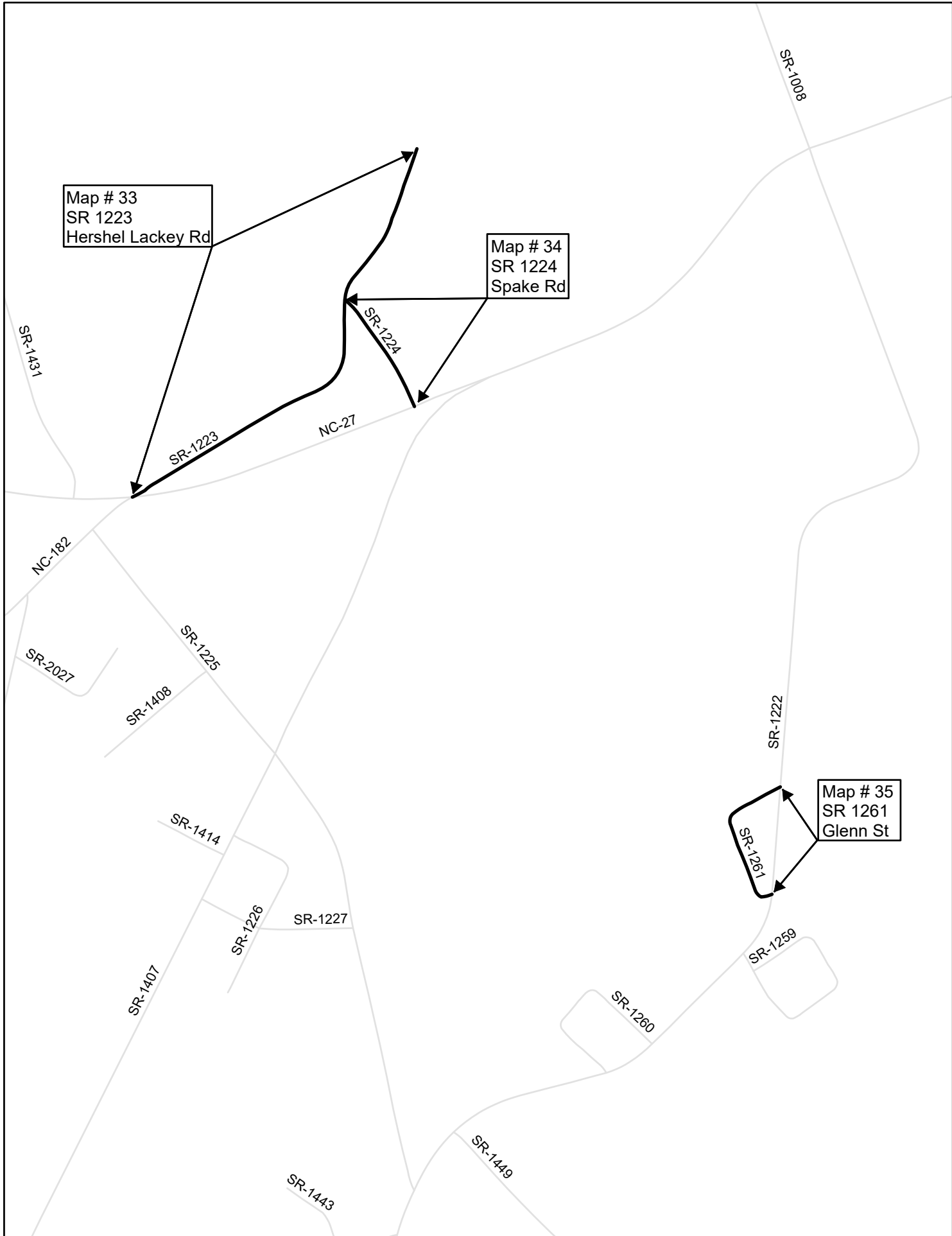

PAVEMENT SCHEDULE

C1	PROP. APPROX. 1" ASPHALT CONCRETE SURFACE COURSE, TYPE S4.75A, AT AN AVERAGE RATE OF 100 LBS. PER SQ. YD.
----	---

NOTE: PAVEMENT EDGE SLOPES ARE 1:1 UNLESS SHOWN OTHERWISE.
 MAINTAIN PROPER CROWN FOR DRAINAGE OF THE ROAD SURFACE.

PROJ. REFERENCE NO.	SHEET NO.	TOTAL SHEETS
	16	
STATE PROJ. NO.	CONTRACT PROJ. NO.	DESCRIPTION
2025CPT.12.11.20232	DL00346	PRESEVATION
2025CPT.12.11.20362		
2025CPT.12.11.20552		

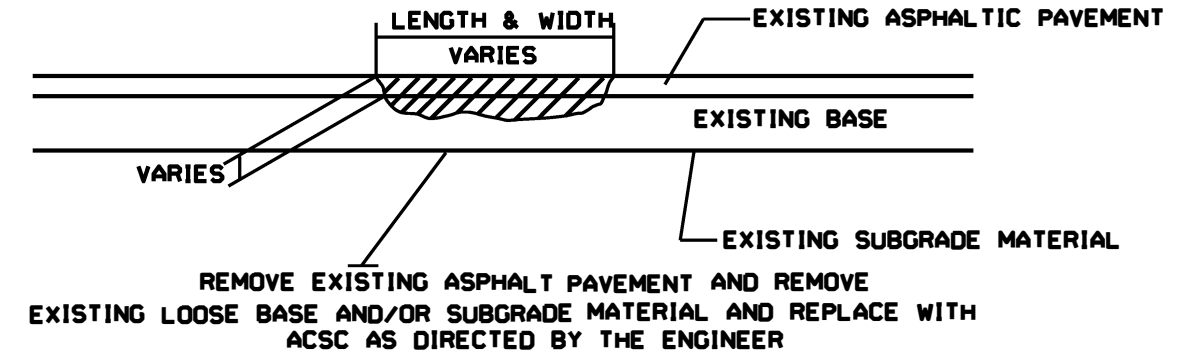
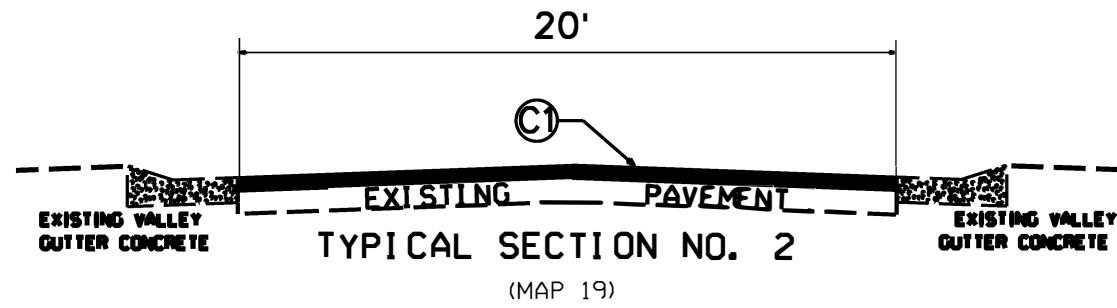
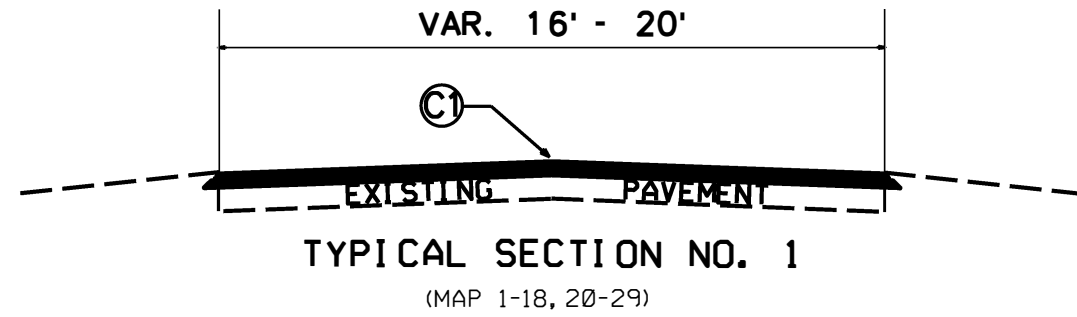

PARTIAL DEPTH PAVEMENT REPAIR

PROJECT NO.	SHEET NO.	TOTAL NO.
2025CPT.12.11.20232, 2025CPT.12.11.20362	17	

SUMMARY OF QUANTITIES

PROJECT NO	COUNTY	MAP NO	ROUTE	DESCRIPTION	TYP NO	LANES	LANE TYPE	FINAL SURFACE TESTING REQUIRED	WARM MIX ASPHALT REQUIRED	LENGTH	WIDTH	BEGIN MP	END MP	122000000-E		152600000-E		169300000-E	
														INCIDENTAL STONE	TONS	SURFACE COURSE, S4/75A	TONS	ASPHALT BINDER FOR PLANT MIX	TONS
2025CPT.12.11.20232	Cleveland	1	SR-1848 / HATCHER RD	FROM SR-1908 / NEW PROSPECT CH RD TO DEAD END	1	2	2WU	NO	NO	0.39	18	0	0.39	2	250	18			
2025CPT.12.11.20232	Cleveland	2	SR-1823 / OLD SCHOOL RD	FROM SR-1811 / RAMSEUR CH RD TO DEAD END	1	2	2WU	NO	NO	0.51	17	0	0.51	3	309	22			
2025CPT.12.11.20232	Cleveland	3	SR-2018 / EBENEZER RD	FROM SR-2014 / GOFORTH RD TO SR-2015 / ROLLINGBROOK RD	1	2	2WU	NO	NO	1.43	20	0	1.43	5	1,019	71			
2025CPT.12.11.20232	Cleveland	4	SR-2039 / WRIGHT RD	FROM SR-2038 / DILLON RD TO CUL-DE-CIRCLE	1	2	2WU	NO	NO	0.91	19	0.4	1.31		616	43			
2025CPT.12.11.20232	Cleveland	5	SR-2142 / BRANCHWOOD CIR	FROM SR-2018 / EBENEZER RD TO SR-2018 / EBENEZER RD	1	2	2WU	NO	NO	0.91	19	0	0.91	3	616	43			
2025CPT.12.11.20232	Cleveland	6	SR-2143 / RIDGEVIEW DR	FROM SR-2142 / BRANCHWOOD CIR TO SR-2142 / BRANCHWOOD CIR	1	2	2WU	NO	NO	0.13	17	0	0.13		79	6	10		
2025CPT.12.11.20232	Cleveland	7	SR-2146 / PUTNAM PL	FROM SR-2018 / EBENEZER RD TO END MAINT 0.03	1	2	2WU	NO	NO	0.03	18	0	0.03		19	1			
2025CPT.12.11.20232	Cleveland	8	SR-2632 / WALNUT ACRE DR	FROM SR-2039 / WRIGHT RD TO END MAINT 0.20	1	2	2WU	NO	NO	0.2	17	0	0.2		121	8			
2025CPT.12.11.20232	Cleveland	9	SR-2502 / MULL ST	FROM SR-1232 / CARMEL DR TO SR-2557 / VICTORY LN	1	2	2WU	NO	NO	0.19	17	0	0.19		115	8	11		
2025CPT.12.11.20232	Cleveland	10	SR-2556 / E GREENE ST	FROM SR-1232 / CARMEL DR TO SR-2557 / VICTORY LN	1	2	2WU	NO	NO	0.19	18	0	0.19		122	9	13		
2025CPT.12.11.20232	Cleveland	11	SR-2557 / VICTORY LN	FROM SR-2256 / E GREENE ST TO DEAD END	1	2	2WU	NO	NO	0.18	18	0	0.18		116	8			
2025CPT.12.11.20232	Cleveland	12	SR-2562 / KEETER ST	FROM SR-2502 / MULL ST TO SR-2556 / E GREENE ST	1	2	2WU	NO	NO	0.16	18	0	0.16		103	7			
TOTAL FOR PROJ NO. 2025CPT.12.11.20232														8	3,485	244	34		
2025CPT.12.11.20362	Gaston	13	SR-1212 / LEWIS CURRY RD	FROM SR-1116 / MOUNTAIN CREST DR TO END PAVEMENT	1	2	2WU	NO	NO	0.19	16	0	0.19		108	8			
2025CPT.12.11.20362	Gaston	14	SR-1391 / GAMBLE LOOP RD	FROM SR-1310 / HILLCREST DR TO END MAINT 0.12	1	2	2WU	NO	NO	0.12	19	0	0.12		81	6			
2025CPT.12.11.20362	Gaston	15	SR-1477 / CAMPBELL RD	FROM SR-1402 / LONG CREEK RD TO END PAVT	1	2	2WU	NO	NO	0.16	20	0	0.16		114	8	15		
2025CPT.12.11.20362	Gaston	16	SR-1482 / WILSON BRIDGES RD	FROM SR-1409 / SUNNYSIDE SHADY REST RD TO END MAINT 0.396	1	2	2WU	NO	NO	0.4	17	0	0.4		243	17			
2025CPT.12.11.20362	Gaston	17	SR-1672 / WH MISER RD	FROM SR-1609 / LONG SHOALS RD TO END MAINT	1	2	2WU	NO	NO	0.19	17	0	0.19		115	8			
2025CPT.12.11.20362	Gaston	18	SR-1699 / CARPENTER DR	FROM SR-1609 / LONG SHOALS RD TO END MAINT 0.51	1	2	2WU	NO	NO	0.51	17	0	0.51		309	22	15		
2025CPT.12.11.20362	Gaston	19	SR-1754 / WAGON TRL	FROM SR-1689 / CARPENTER DR TO CUL-DE-SAC	2	2	2WU	NO	NO	0.37	20	0	0.37		264	18			
2025CPT.12.11.20362	Gaston	20	SR-1759 / DEER RUN DR	FROM SR-1617 / GASTON-WEBBS CHAPEL RD TO CUL-DE-SAC	1	2	2WU	NO	NO	0.36	20	0	0.36		257	18			
2025CPT.12.11.20362	Gaston	21	SR-1760 / WHITETAIL CT	FROM SR-1759 / DEER RUN CT TO CUL-DE-SAC	1	2	2WU	NO	NO	0.17	20	0	0.17		121	8			
2025CPT.12.11.20362	Gaston	22	SR-1761 / DOE MEADOW CT	FROM SR-1759 / DEER RUN DR TO CUL-DE-SAC	1	2	2WU	NO	NO	0.21	19	0	0.21		142	10			
2025CPT.12.11.20362	Gaston	23	SR-1762 / FAWN CT	FROM SR-1761 / DOE MEADOW CT TO CUL-DE-SAC	1	2	2WU	NO	NO	0.08	18	0	0.08		51	4			
2025CPT.12.11.20362	Gaston	24	SR-1852 / LINEBERGER ST	FROM NC-275 / DALLAS STANLEY HWY TO DEAD END	1	2	2WU	NO	NO	0.19	18	0	0.19		122	9			
2025CPT.12.11.20362	Gaston	25	SR-1854 / CEDAR LN	FROM NC-275 / DALLAS STANLEY HWY TO DEAD END	1	2	2WU	NO	NO	0.26	18	0	0.26		167	12			
2025CPT.12.11.20362	Gaston	26	SR-1870 / FARMINGTON DR	FROM NC-275 / DALLAS STANLEY HWY TO CUL-DE-SAC	1	2	2WU	NO	NO	0.21	19	0	0.21		142	10			
2025CPT.12.11.20362	Gaston	27	SR-1882 / PROPT RD	FROM SR-1802 / SPRINGS RD TO DEAD END	1	2	2WU	NO	NO	0.22	18	0	0.22		141	10	15		
2025CPT.12.11.20362	Gaston	28	SR-1886 / CANE FOREST DR	FROM SR-1820 / ALEXIS HIGH SHOALS RD TO CUL-DE-SAC	1	2	2WU	NO	NO	0.22	18	0	0.22		141	10	7		
2025CPT.12.11.20362	Gaston	29	SR-3200 / NICOLE TER	FROM SR-2000 / HICKORY GROVE RD TO CUL-DE-SAC	1	2	2WU	NO	NO	0.26	19	0	0.26		176	12	28		
TOTAL FOR PROJ NO. 2025CPT.12.11.20362														7	2,694	190	80		
2025CPT.12.11.20552	Lincoln	30	SR-1849 / HEAVENERS FARM CT	FROM SR-1186 / HOWARDS CREEK SCH RD TO CUL-DE-SAC	1	2	2WU	NO	NO	0.29	19	0	0.29		214	15	80		
2025CPT.12.11.20552	Lincoln	31	SR-1848 / FRANKS RD	FROM SR-1187 / HARMON RD TO SR-1849 / HEAVENERS FARM CT	1	2	2WU	NO	NO	0.22	19	0	0.22		142	10	60		
2025CPT.12.11.20552	Lincoln	32	SR-1546 / HALLMAN DR	FROM SR-1169 / GROUSE RD TO DEAD END	1	2	2WU	NO	NO	0.47	18	0	0.47		298	21	50		
2025CPT.12.11.20552	Lincoln	33	SR-1223 / HERSHEL LACKEY RD	FROM NC 27 TO END MAINT	1	2	2WU	NO	NO	0.52	18	0	0.52		319	22	100		
2025CPT.12.11.20552	Lincoln	34	SR-1224 / SPAKE RD	FROM NC 27 TO SR 1223 (HERSHEL LACKEY RD)	1	2	2WU	NO	NO	0.15	18	0	0.15		92	6	20		
2025CPT.12.11.20552	Lincoln	35	SR-1261 / GLENN ST	FROM SR-1222 (S GROVE ST) TO SR-1222 (S GROVE ST)	1	2	2WU	NO	NO	0.2	21	0	0.2		169	12	60		
2025CPT.12.11.20552	Lincoln	36	SR-1283 / MULL RD	FROM US 321 BUS TO DEAD END	1	2	2WU	NO	NO	0.69	21	0	0.69		507	35	100		
TOTAL FOR PROJ NO. 2025CPT.12.11.20552														9	1,741	121	470		
GRAND TOTAL														24	7,920	555	584		

PROJECT NO.	SHEET NO.	TOTAL NO.
2025CPT.12.11.20232, 2025CPT.12.11.20362	18	

THERMOPLASTIC AND PAINT QUANTITIES

PROJECT NO	COUNTY	MAP NO	ROUTE	DESCRIPTION	TYP NO	LANES	LANE TYPE	LENGTH	WIDTH	BEGIN MP	END MP	4413000000-E		4457000000-N		4810000000-E		
												WORK ZONE	ADV/GEN	TRAFFIC	CONTROL	4" WHITE	4" YELLOW	
								MI	FT			SF	LS	LF	LF	LF		
2025CPT.12.11.20232	Cleveland	1	SR-1948 / HATCHER RD	FROM SR-1908 / NEW PROSPECT CH RD TO DEAD END	1	2	2WU	0.39	18	0	0.39	84						
2025CPT.12.11.20232	Cleveland	2	SR-1823 / OLD SCHOOL RD	FROM SR-1811 / RAMSEUR CH RD TO DEAD END	1	2	2WU	0.51	17	0	0.51	84						
2025CPT.12.11.20232	Cleveland	3	SR-2018 / EBENEZER RD	FROM SR-2014 / GOFORTH RD TO SR-2015 / ROLLINGBROOK RD	1	2	2WU	1.43	20	0	1.43	84				30,774	30,774	
2025CPT.12.11.20232	Cleveland	4	SR-2039 / WRIGHT RD	FROM SR-2038 / DILLON RD TO CUL-DE-CIRCLE	1	2	2WU	0.91	19	0.4	1.31	84				19,583	12,012	
2025CPT.12.11.20232	Cleveland	5	SR-2142 / BRANCHWOOD CIR	FROM SR-2018 / EBENEZER RD TO SR-2018 / EBENEZER RD	1	2	2WU	0.91	19	0	0.91	84				19,583	19,583	
2025CPT.12.11.20232	Cleveland	6	SR-2143 / RIDGEVIEW DR	FROM SR-2142 / BRANCHWOOD CIR TO SR-2142 / BRANCHWOOD CIR	1	2	2WU	0.13	17	0	0.13	84				2,798	2,798	
2025CPT.12.11.20232	Cleveland	7	SR-2146 / PUTNAM PL	FROM SR-2018 / EBENEZER RD TO END MAINT 0.03	1	2	2WU	0.03	18	0	0.03	84						
2025CPT.12.11.20232	Cleveland	8	SR-2632 / WALNUT ACRE DR	FROM SR-2039 / WRIGHT RD TO END MAINT 0.20	1	2	2WU	0.2	17	0	0.2	84						
2025CPT.12.11.20232	Cleveland	9	SR-2502 / MULL ST	FROM SR-1232 / CARMEL DR TO SR-2557 / VICTORY LN	1	2	2WU	0.19	17	0	0.19	84				4,089	4,089	
2025CPT.12.11.20232	Cleveland	10	SR-2556 / E GREENE ST	FROM SR-1409 / SUNNYSIDE SHADY REST RD TO END MAINT 0.396	1	2	2WU	0.19	18	0	0.19	84				4,089	4,089	
2025CPT.12.11.20232	Cleveland	11	SR-2557 / VICTORY LN	FROM SR-2256 / E GREENE ST TO DEAD END	1	2	2WU	0.18	18	0	0.18	84				3,874	3,874	
2025CPT.12.11.20232	Cleveland	12	SR-2562 / KEETER ST	FROM SR-2502 / MULL ST TO SR-2556 / E GREENE ST	1	2	2WU	0.16	18	0	0.16	84				3,443	3,443	
TOTAL FOR PROJ NO. 2025CPT.12.11.20232								5.23				1,008			88,233	80,662		
2025CPT.12.11.20362	Gaston	13	SR-1212 / LEWIS CURRY RD	FROM SR-1116 / MOUNTAIN CREST DR TO END PAVEMENT	1	2	2WU	0.19	16	0	0.19	84						
2025CPT.12.11.20362	Gaston	14	SR-1391 / GAMBLE LOOP RD	FROM SR-1310 / HILLCREST DR TO END MAINT 0.12	1	2	2WU	0.12	19	0	0.12	84						
2025CPT.12.11.20362	Gaston	15	SR-1477 / CAMPBELL RD	FROM SR-1402 / LONG CREEK RD TO END PVMT	1	2	2WU	0.16	20	0	0.16	84						
2025CPT.12.11.20362	Gaston	16	SR-1482 / WILSON BRIDGES RD	FROM SR-1409 / SUNNYSIDE SHADY REST RD TO END MAINT 0.396	1	2	2WU	0.4	17	0	0.4	84						
2025CPT.12.11.20362	Gaston	17	SR-1672 / WH KISER RD	FROM SR-1609 / LONG SHOALS RD TO END MAINT	1	2	2WU	0.19	17	0	0.19	84						
2025CPT.12.11.20362	Gaston	18	SR-1689 / CARPENTER DR	FROM SR-1609 / LONG SHOALS RD TO END MAINT 0.51	1	2	2WU	0.51	17	0	0.51	84						
2025CPT.12.11.20362	Gaston	19	SR-1754 / WAGON TRL	FROM SR-1689 / CARPENTER DR TO CUL-DE-SAC	2	2	2WU	0.37	20	0	0.37	84						
2025CPT.12.11.20362	Gaston	20	SR-1759 / DEER RUN DR	FROM SR-1617 / GASTON-WEBBS CHAPEL RD TO CUL-DE-SAC	1	2	2WU	0.36	20	0	0.36	84						
2025CPT.12.11.20362	Gaston	21	SR-1760 / WHITE TAIL CT	FROM SR-1759 / DEER RUN CT TO CUL-DE-SAC	1	2	2WU	0.17	20	0	0.17	84						
2025CPT.12.11.20362	Gaston	22	SR-1761 / DOE MEADOW CT	FROM SR-1759 / DEER RUN DR TO CUL-DE-SAC	1	2	2WU	0.21	19	0	0.21	84						
2025CPT.12.11.20362	Gaston	23	SR-1762 / FAWN CT	FROM SR-1761 / DOE MEADOW CT TO CUL-DE-SAC	1	2	2WU	0.08	18	0	0.08	84						
2025CPT.12.11.20362	Gaston	24	SR-1852 / LNEBERGER ST	FROM NC-275 / DALLAS STANLEY HWY TO DEAD END	1	2	2WU	0.19	18	0	0.19	84						
2025CPT.12.11.20362	Gaston	25	SR-1854 / CEDAR LN	FROM NC-275 / DALLAS STANLEY HWY TO DEAD END	1	2	2WU	0.26	18	0	0.26	84						
2025CPT.12.11.20362	Gaston	26	SR-1870 / FARMINGTON DR	FROM NC-275 / DALLAS STANLEY HWY TO CUL-DE-SAC	1	2	2WU	0.21	19	0	0.21	84						
2025CPT.12.11.20362	Gaston	27	SR-1882 / PROPST RD	FROM SR-1802 / SPRINGS RD TO DEAD END	1	2	2WU	0.22	18	0	0.22	84						
2025CPT.12.11.20362	Gaston	28	SR-1886 / CANE FOREST DR	FROM SR-1820 / ALEXIS HIGH SHOALS RD TO CUL-DE-SAC	1	2	2WU	0.22	18	0	0.22	84						
2025CPT.12.11.20362	Gaston	29	SR-3200 / NICOLE TER	FROM SR-2000 / HICKORY GROVE RD TO CUL-DE-SAC	1	2	2WU	0.26	19	0	0.26	84						
TOTAL FOR PROJ NO. 2025CPT.12.11.20362								4.12				1,428			113,333	105,762		
GRAND TOTAL								11.89				2,628		1	113,333	105,762	219,095	
2025CPT.12.11.20552	Lincoln	30	SR-1849 / HEAVENERS FARM CT	FROM SR-1186 HOWARDS CREEK SCH RD TO CUL-DE-SAC	1	2	2WU	0.29	19	0	0.29	24						
2025CPT.12.11.20552	Lincoln	31	SR-1848 / FRANKS RD	FROM SR-1187 (HARMON RD) TO SR-1849 (HEAVNER FARM CT)	1	2	2WU	0.22	19	0	0.22	24						
2025CPT.12.11.20552	Lincoln	32	SR-1546 / HALLMAN DR	FROM SR-1169 (CROUSE RD) TO DEAD END	1	2	2WU	0.47	18	0	0.47	24						
2025CPT.12.11.20552	Lincoln	33	SR-1223 / HERSHEL LACKEY RD	FROM NC 27 TO END MAINT	1	2	2WU	0.52	18	0	0.52	24				7,500	7,500	
2025CPT.12.11.20552	Lincoln	34	SR-1224 / SPAKE RD	FROM NC 27 TO SR-1223 (HERSHEL LACKEY RD)	1	2	2WU	0.15	18	0	0.15	24				3,000	3,000	
2025CPT.12.11.20552	Lincoln	35	SR-1261 / GLENN ST	FROM SR-1222 (S GROVE ST) TO SR-1222 (S GROVE ST)	1	2	2WU	0.2	21	0	0.2	48				14,600	14,600	
2025CPT.12.11.20552	Lincoln	36	SR-1283 / MULL RD	FROM US 321 BUS TO DEAD END	1	2	2WU	0.69	21	0	0.69	24				25,100	25,100	
TOTAL FOR PROJ NO. 2025CPT.12.11.20552								2.54				192			113,333	105,762	219,095	

SIGNING FOR RESURFACING PROJECTS

LEGEND

┃ STATIONARY SIGN

← DIRECTION OF TRAFFIC FLOW

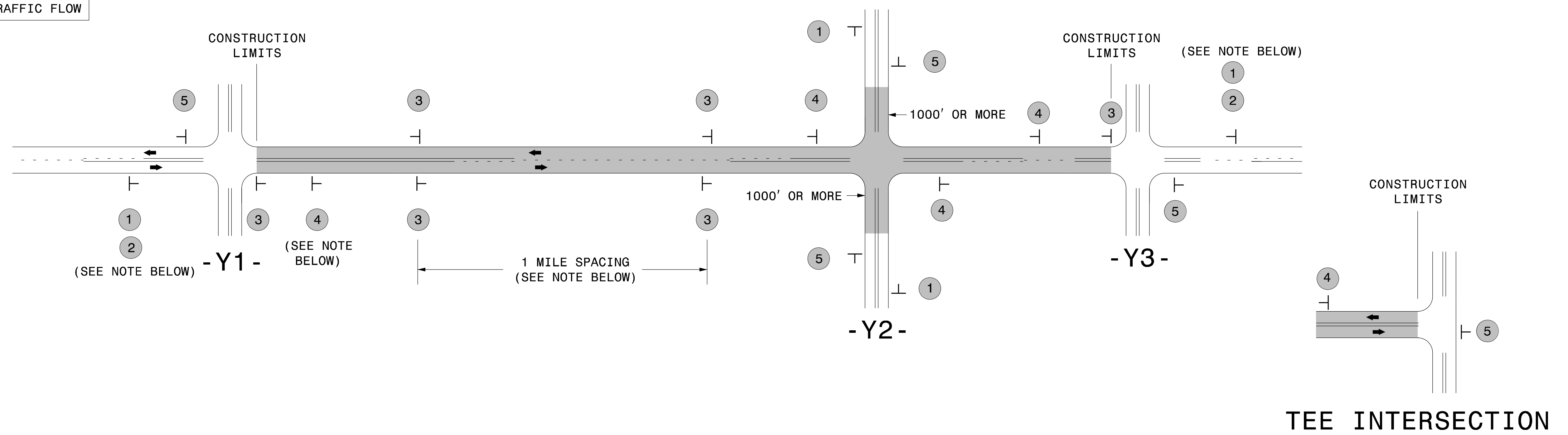

MAINLINE (-L-) SIGNING

-Y- LINE SIGNING

SIGNING NOTES AND PLACEMENT PER DIRECTION	1		PLACE 1000' PRIOR TO BEGINNING OF CONSTRUCTION LIMITS. ONLY USED ON -Y- LINES IF RESURFACING LIMITS EXTEND 1000' ALONG -Y- LINE.	<p>NO REQUIRED STATIONARY SIGNING FOR THE FOLLOWING -Y- LINE CONDITIONS:</p> <ol style="list-style-type: none"> 1) LESS THAN 1000' OF RESURFACING ALONG -Y- LINE 2) SUBDIVISION ROADS 3) DEAD END ROADS <p>WHEN PAVING/CONSTRUCTION ACTIVITIES PROCEED ACROSS AN UNSIGNED -Y- LINE, PORTABLE ADVANCE WARNING SIGNS SHALL BE USED ALONG THE -Y- LINE AS SHOWN BELOW. REMOVE UPON COMPLETION OF WORK.</p> <div style="display: flex; justify-content: space-around;"> <div style="text-align: center;"> W20-1 48" X 48" PLACED 500' IN ADVANCE OF FLAGGER. </div> <div style="text-align: center;"> W20-7 A 48" X 48" PLACED 250' IN ADVANCE OF FLAGGER. </div> </div>
	2		#2 SIGN ONLY USED WHEN CONSTRUCTION LIMITS ARE 2 OR MORE MILES IN LENGTH. ROUND UP TO NEXT WHOLE NUMBER. (NO FRACTIONAL OR DECIMAL NUMBERS)	
	3		- PLACE INITIALLY AT THE CONSTRUCTION LIMITS AND SPACE 1 MILE APART THEREAFTER. - AT TEE INTERSECTIONS INSTALL INITIALLY 1/2 MILE FROM INTERSECTION AND SPACE 1 MILE APART THEREAFTER.	
	4		- THESE ARE FOR -Y- LINES THAT ARE "THROUGH" ROADWAYS. - DEAD END AND SUBDIVISION ROADS ARE NOT "THROUGH" ROADWAYS. - INSTALL 500' +/- FROM EACH -Y- LINE APPROACH AS SHOWN ABOVE. - FOR MULTIPLE -Y- LINES THAT ARE SEPARATED BY 0.25 MILES OR LESS, TREAT AS A SINGLE UNIT AND INSTALL WITHIN 500' OF EACH APPROACH. - A MAXIMUM OF 2 SIGN SETS PER MILE. DO NOT INSTALL WHEN -Y- LINES ARE WITHIN 0.5 MILES FROM "END ROAD WORK" SIGN. - FOR TEE INTERSECTIONS, INSTALL WITHIN 500' +/- OF THE INTERSECTION ALONG -L- LINE.	
	5		PLACE 500' FOLLOWING THE END OF CONSTRUCTION LIMITS OR AS SHOWN WHEN WORK ENDS AT A 3-WAY TEE INTERSECTION.	

THE ABOVE SIGNS ARE ALL THAT ARE REQUIRED FOR A CONTRACTOR TO BEGIN A RESURFACING CONTRACT. ANY ADDITIONAL SIGNS REQUESTED BY NCDOT DIVISIONS SHALL BE INSTALLED WITHIN 7 BUSINESS DAYS OF THE START OF CONTRACT WORK.

MAPS LESS THAN 2 MILES

FOR RESURFACING MAPS WITH CONSTRUCTION LIMITS LESS THAN 2 MILES IN LENGTH, NO STATIONARY SIGNS ARE REQUIRED. USE PORTABLE "ROAD UNDER CONSTRUCTION" OR "ROAD WORK AHEAD" SIGNS IN LIEU OF STATIONARY ADVANCE WARNINGS SIGNS.

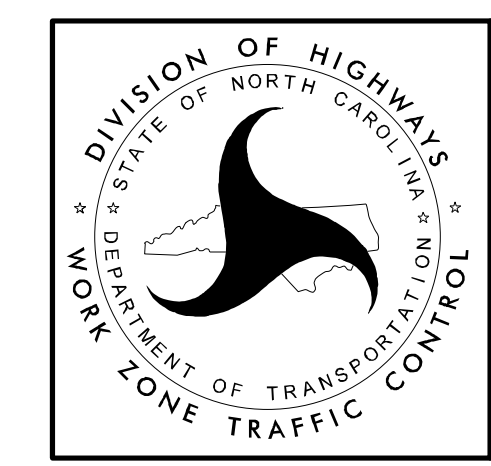

ADVANCE WARNING SIGNS FOR RURAL AND SUBURBAN 2-LANE ROADWAY RESURFACING